

Why an Octagon?

An octagon encloses
**20% more space than
a square!**

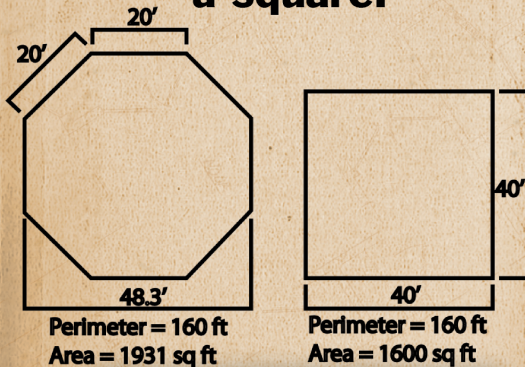

The Octagon Cabin:

- More natural light
- Easier to heat and cool
- Visually unique
- Provides more volume
- Fewer materials
- Less wind resistance

**Combine Two Kits
for more space!**

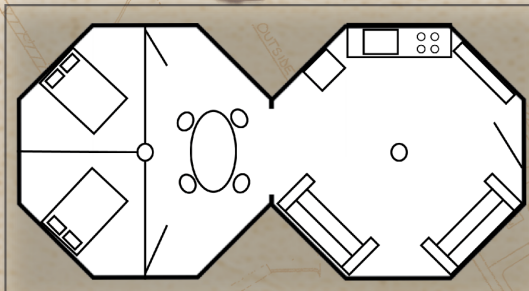

What are Structural Insulated Panels?

An SIP (structural insulated panel) is a very efficient building material comprised of a foam core glued between two strong wood panels.

This eliminates the need for stick framing and separate insulation.

**Building with
SIP panels
saves time.**

**Significant and real
Energy Savings
compared to stick
and other building
methods.**

**SIPs are
"Green"
Building
Products**

- Tough and Durable
- Air Tight envelope
- Low Waste
- Solid Surface
- Straighter Walls
- High R-Value

Introducing:

The PrepCabin Octagon Cabin Kit



Contact Nick Gillick for more information

Email: Nick@PrepCabin.com

Or visit www.PrepCabin.com/octagon-cabin-kit

Two Sizes

- 330 sq ft
- or
- 740 sq ft

- Super Efficient
- Easy to Maintain
- Green Building
- Affordable



Engineered and manufactured in TX
exclusively for PrepCabin by an ENERGY
STAR partner and LEED certified facility.

**Expertly Engineered
and Manufactured in:**



Less Framing, Less Labor!

Assembly of the PrepCabin Octagon Cabin Kit is straightforward and simple.

The panels arrive ready to assemble and are pre-insulated.

Arrange the panels in place on top of your foundation and secure them with included splines and screws.

With help from a few friends assemble a 20' kit in just 1 day.

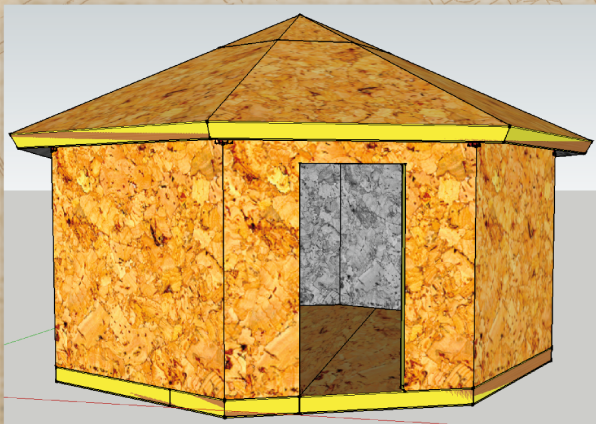

Assembled kit before wall wrap or siding

Solid panel walls provide an excellent nail and screw base eliminating any searching for studs.

Options and Pricing

Option A: 20' Width Cabin Kit

\$11,999 + applicable taxes.

20' width is approximately 330 square feet.

Only \$36 per square foot.

That's 2,640 cubic feet of inside space!

Option B: 30' Width Cabin Kit

\$19,999 + applicable taxes

30' width is approximately 740 square feet.

Only \$27 per square foot.

The 30' cabin provides almost 7,000 cubic feet of interior space!

* Kits are made with 8ft walls.

* 50% deposit required

* Shipping and freight separate.

* Quotes available for custom sizes.

Prices as of 06/2015: Visit
www.PrepCabin.com/octagon-cabin-kit
For current pricing or to request a quote.

What's Included?

Material list for a 20' width shell kit:

- 16 SIP roof panels (R Value 24.3)
- 8 SIP wall panels (R Value 16)
- 3 SIP floor panels (R Value 24.3)
- 64 SIP splines
- 2 Do-All-Ply sealant dispensers
- 65 tubes of Do-All-Ply sealant
- 120 linear feet of 2x6 lumber (plumb cut)
- 200 linear feet of 2x8 lumber (plumb cut)
- 136 linear feet of 2x4 lumber (square cut)
- 312 linear feet of 2x6 lumber (square cut)
- 4 rolls of SIP tape
- 160 9" wood screws
- 165' roll of wall wrap tape
- 1 roll of 10'x150' wall wrap

* Timbor treated SIP panels for mold and termite prevention

* FrameGuard treatment for all dimensional lumber

* 30' Cabin Shell material list available upon request

* Detailed instructions included

* Phone and email support

Tested to meet Fire Codes
Meets IBC and IRC Building Codes

